

Outdoor single-pole disconnectors DRIBO FIs

rated voltage 25 and 38,5 kV
rated current 400 A



DRIBO, spol. s r.o.

Pražákova 36
619 00 Brno
Czech Republic

Tel.: +420 533 101 111, Fax: +420 543 216 619, E-mail: dribo@dribo.cz, Internet: <http://www.dribo.eu>

ISO 9001
ISO 14001
BUREAU VERITAS
Certification



DRIBO FIs outdoor single-pole disconnectors

These switching devices are designed for assembly and service groups. The disconnectors are used for temporary switching-off of those parts of power lines, on which works are to be carried out.

The disconnectors meet the requirements of the EN 62271-1 and EN 62271-102 standards. The insulators comply with the stipulations imposed on the pollution degree IV, as defined by the ČSN 33 0405 standard.

The simple and sturdy construction of the disconnectors provides for the necessary reliability of operation in the largest scope of various operating environments.

The supporting parts are made of hot galvanized steel. The contact springs, minor parts and the arc-quenching contacts of the DRIBO FIs type of disconnector are made of stainless steel.

All current-carrying parts are made of electroplated silver-coated electrolytical copper.

The dimensioning of the conductors of which the current-carrying path consists, and the appropriate pressure of the contact springs made of stainless steel, give rise to the prerequisites necessary for reliable and defect-free switching.

The short-circuit parameters are met with a large margin.

The switch disconnectors are operated using pull rods of 5 to 6 m length, or by the „Powerman Hot“ 40,5kV pull rod set, with a special adapter.

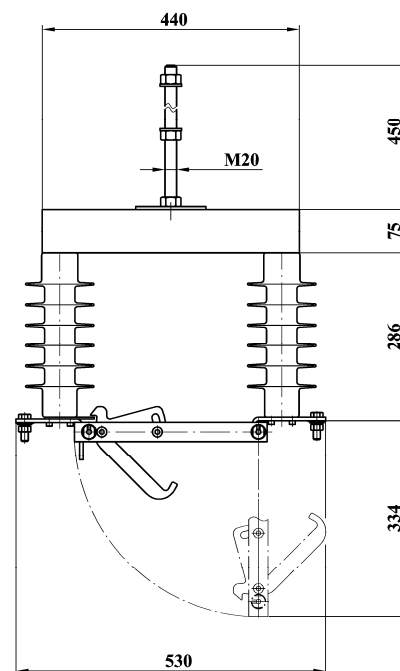

Technical data

rated voltage	U	kV	25
rated current	I_r	A	400
rated short-time withstand power frequency voltage / 1 min. to be applied in both dry and wet conditions			
across the insulating distance		kV	60
rated lightning pulse withstand voltage			
across the insulating distance		kV	145

Assembly works

During the transport the M20 supporting stud bolt is dismantled. After having received the product this stud bolt is to be linked with the supporting structure.

The corresponding poles of the DRIBO FIs disconnector are mounted on the pillar in a way as shown in the picture; with end poles fixed using the M20 stud bolts, and with the central pole mounted to the side of the pillar.

